

Construction height only 78 cm

extremely low!



■ WC-block 78 cm high for flush panel "Omega" from Geberit®, actuation from the front or from above

Art.-No. 1478.N

515,- €

Height 78 cm, Width 50 cm, Depth 15 cm

Ideally suited for particularly low construction height requirements
such as e.g. roof slopes, window sills or integration under washing
area coverings!

With dual volume flush technology and completely fitted for wall-hanging WC:

- adjustable in 4-stages
- for screwing in front of the wall or to be walled in (lateral mortar grooves)
- with fastening material
- with sound proof set
- metre indication line at 0.5 m
- with height-adjustable feet (up to 15 cm)
- U-shaped with assembly room cover below
- moulded cistern
- Flush volume max. 6 litres
- site protection caps
- corner valve 1/2"
- with WC connection pipes (90°-bend made of PE Ø 90/90 mm and PE adaptor Ø 90/110 mm)
- with WC fastening set
- with WC connection pipes Ø 90 mm
- without flush panel
- actuation from the front resp. from above
- equipment for shower WCs on request and at extra cost possible von Geberit®

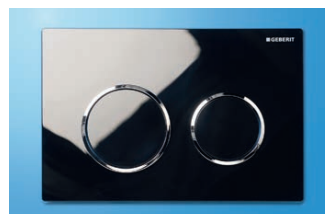
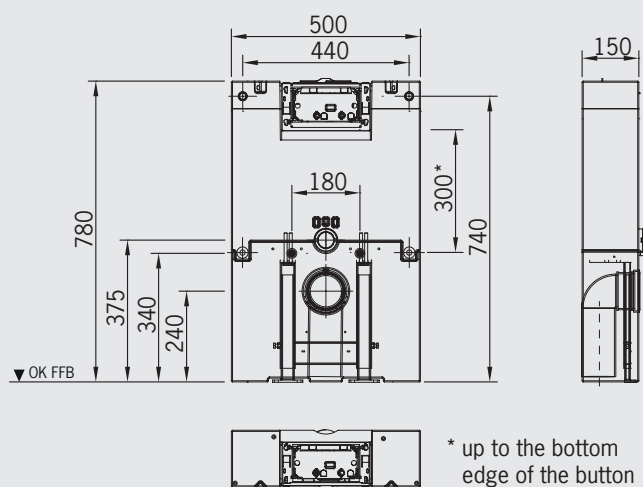

Omega 20



Omega 30

- **Note:** When using the "Omega 60" flush panel, the cladding on the block must be at least 24 mm thick and at least 28 mm when actuation from above.